

Computer major components

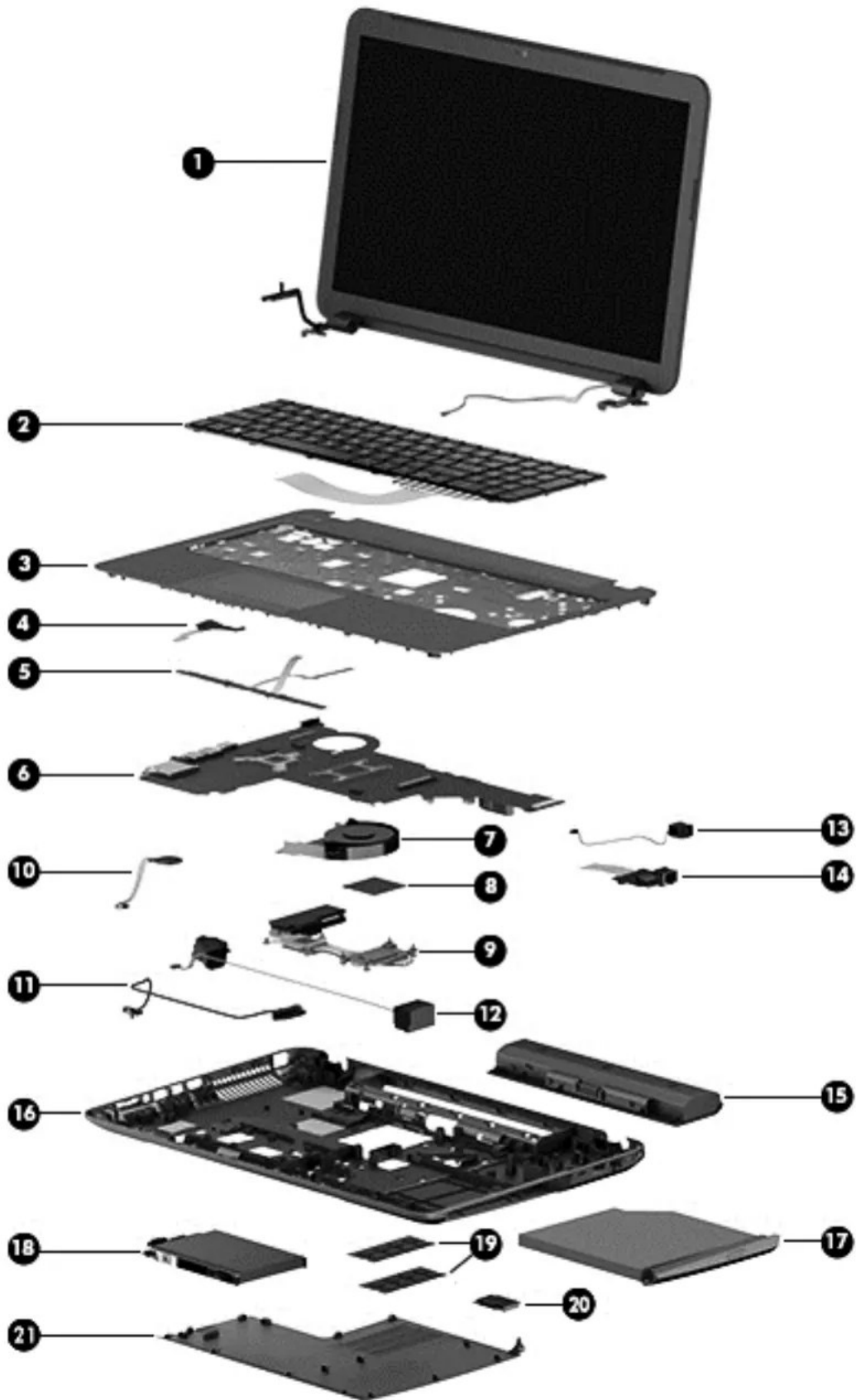

Item Component Spare part number

(1) Display assembly: The display assembly is spared at the subcomponent level only. For more display assembly spare part information, see [Display assembly subcomponents on page 28](#).

(2) Keyboard (includes keyboard cable):

In black finish for use on all computer models in Belgium 719853-A41

In black finish for use on all computer models in Bulgaria 719853-261

In black finish for use on all computer models in Canada 719853-DB1

In black finish for use on all computer models in the Czech Republic and Slovakia 719853-FL1

In black finish for use on all computer models in Denmark, Finland, and Norway 719853-DH1

In black finish for use on all computer models in France 719853-051

In black finish for use on all computer models in Germany 719853-041

In black finish for use on all computer models in Greece 719853-151

In black finish for use on all computer models in Hungary 719853-211

In black finish for use on all computer models in Israel 719853-BB1

In black finish for use on all computer models in Italy 719853-061

In black finish for use on all computer models in Japan 719853-291

In black finish for use on all computer models in the Netherlands 719853-B31

In black finish for use only on computer models equipped with an Intel processor
in Northwest Africa 719853-FP1

In black finish for use on all computer models in Portugal 719853-131

In black finish for use on all computer models in Romania 719853-271

In black finish for use on all computer models in Russia 719853-251

In black finish for use only on computer models equipped with an Intel processor
in Saudi Arabia 719853-171

In black finish for use on all computer models in Slovenia 719853-BA1

In black finish for use on all computer models in South Korea 719853-AD1

In black finish for use on all computer models in Spain 719853-071

In black finish for use on all computer models in Switzerland 719853-BG1

In black finish for use on all computer models in Taiwan 719853-AB1

In black finish for use on all computer models in Thailand 719853-281

In black finish for use on all computer models in Turkey 719853-141

In black finish for use on all computer models in the United Kingdom and Singapore 719853-031

In black finish for use on all computer models in the United States 719853-001

In white finish for use on all computer models in Belgium 720597-A41

Item Component Spare part number

In white finish for use on all computer models in Bulgaria 720597-261

In white finish for use on all computer models in Canada 720597-DB1

In white finish for use on all computer models in the Czech Republic and Slovakia 720597-FL1

In white finish for use on all computer models in Denmark, Finland, and Norway 720597-DH1

In white finish for use on all computer models in France 720597-051

In white finish for use on all computer models in Germany 720597-041

In white finish for use on all computer models in Greece 720597-151

In white finish for use on all computer models in Hungary 720597-211

In white finish for use on all computer models in Israel 720597-BB1

In white finish for use on all computer models in Italy 720597-061

In white finish for use on all computer models in Japan 720597-291

In white finish for use on all computer models in the Netherlands 720597-B31

In white finish for use only on computer models equipped with an Intel processor
in Northwest Africa 720597-FP1

In white finish for use on all computer models in Portugal 720597-131

In white finish for use on all computer models in Romania 720597-271

In white finish for use on all computer models in Russia 720597-251

In white finish for use only on computer models equipped with an Intel processor
in Saudi Arabia 720597-171

In white finish for use on all computer models in Slovenia 720597-BA1

In white finish for use on all computer models in South Korea 720597-AD1

In white finish for use on all computer models in Spain 720597-071

In white finish for use on all computer models in Switzerland 720597-BG1

In white finish for use on all computer models in Taiwan 720597-AB1

In white finish for use on all computer models in Thailand 720597-281

In white finish for use on all computer models in Turkey 720597-141

In white finish for use on all computer models in the United Kingdom and Singapore 720597-031

In white finish for use on all computer models in the United States 720597-001

(3) Top cover (includes TouchPad):

In flying red finish 719868-001

In pearl white finish 719867-001

In regal purple finish 719870-001

In revolutionary blue finish 719869-001

Item Component Spare part number	
In sparkling black and silver finish 719871-001	
(4) Power button board (includes cable) 719843-001	
(5) TouchPad button board (includes TouchPad board cable and TouchPad button board cable)	720299-001
(6) System board (includes replacement thermal material):	
For use only on computer models equipped with an AMD A10, A8, A6-5350, or A4 processor, a graphics subsystem with 1-GB of discrete memory, and the Windows 8 Standard operating system	720692-501
For use only on computer models equipped with an AMD A10, A8, A6-5350, or A4 processor, a graphics subsystem with 1-GB of discrete memory, and the Linux operating system	720692-001
Equipped with an AMD A6-5200 2.00-GHz processor (2.00-MB L2 cache, 1600-MHz FSB, DDR3L, quad core, 25 W), a graphics subsystem with 1-GB of discrete memory, and the Windows 8 Standard operating system	722205-501
Equipped with an AMD A6-5200 2.00-GHz processor (2.00-MB L2 cache, 1600-MHz FSB, DDR3L, quad core, 25 W), a graphics subsystem with 1-GB of discrete memory, and the Windows 8 Standard operating system	722205-001
For use only on computer models equipped with an AMD A10, A8, A6-5350, or A4 processor, a graphics subsystem with UMA memory, and the Windows 8 Standard operating system	720691-501
For use only on computer models equipped with an AMD A10, A8, A6-5350, or A4 processor, a graphics subsystem with UMA memory, and the Linux operating system	720691-001
Equipped with an AMD A6-5200 2.00-GHz processor (2.00-MB L2 cache, 1600-MHz FSB, DDR3L, quad core, 25 W), a graphics subsystem with 1-GB of discrete memory, and the Windows 8 Standard operating system	722204-501
Equipped with an AMD A6-5200 2.00-GHz processor (2.00-MB L2 cache, 1600-MHz FSB, DDR3L, quad core, 25 W), a graphics subsystem with 1-GB of discrete memory, and the Linux operating system	722204-001
Equipped with an AMD A4-5000 1.50-GHz processor (1600-MHz FSB, 2.0-MB L2 cache, DDR3L, quad core, 15 W), a graphics subsystem with UMA memory, and the Windows 8 Standard operating system	731534-501
Equipped with an AMD A4-5000 1.50-GHz processor (1600-MHz FSB, 2.0-MB L2 cache, DDR3L, quad core, 15 W), a graphics subsystem with UMA memory, and the Linux operating system	731534-001
For use only on computer models equipped with the Intel HM86 chipset, a graphics subsystem with 2-GB of discrete memory, and the Windows 8 Professional operating system	713256-601
For use only on computer models equipped with the Intel HM86 chipset, a graphics subsystem with 2-GB of discrete memory, and the Windows 8 Standard operating system	713256-501
For use only on computer models equipped with the Intel HM86 chipset, a graphics subsystem with 2-GB of discrete memory, and the Linux operating system	713256-001
For use only on computer models equipped with the Intel HM86 chipset, a graphics subsystem with UMA memory, and the Windows 8 Professional operating system	713255-001

Item	Component	Spare part number
	For use only on computer models equipped with the Intel HM86 chipset, a graphics subsystem with UMA memory, and the Windows 8 Standard operating system	713255-501
	For use only on computer models equipped with the Intel HM86 chipset, a graphics subsystem with UMA memory, and the Linux operating system	713255-001
	For use only on computer models equipped with the Intel HM76 chipset, a graphics subsystem with 2-GB of discrete memory, and the Windows 8 Professional operating system	720459-601
	For use only on computer models equipped with the Intel HM76 chipset, a graphics subsystem with 2-GB of discrete memory, and the Windows 8 Standard operating system	720459-501
	For use only on computer models equipped with the Intel HM76 chipset, a graphics subsystem with 2-GB of discrete memory, and the Linux operating system	720459-001
	For use only on computer models equipped with the Intel HM76 chipset, a graphics subsystem with 1-GB of discrete memory, and the Windows 8 Professional operating system	713258-601
	For use only on computer models equipped with the Intel HM76 chipset, a graphics subsystem with 1-GB of discrete memory, and the Windows 8 Standard operating system	713258-501
	For use only on computer models equipped with the Intel HM76 chipset, a graphics subsystem with 1-GB of discrete memory, and the Linux operating system	713258-001
	For use only on computer models equipped with the Intel HM76 chipset, a graphics subsystem with UMA memory, and the Windows 8 Professional operating system	713257-001
	For use only on computer models equipped with the Intel HM76 chipset, a graphics subsystem with UMA memory, and the Windows 8 Standard operating system	713257-501
	For use only on computer models equipped with the Intel HM76 chipset, a graphics subsystem with UMA memory, and the Linux operating system	713257-001
	Equipped with an Intel Dual Core i3-3110M 2.40-GHz processor (3.0-MB L3 cache, 1600-MHz FSB, 35 W), a graphics subsystem with 1-GB of discrete memory, and the Windows 8 Professional operating system	729844-601
	Equipped with an Intel Dual Core i3-3110M 2.40-GHz processor (3.0-MB L3 cache, 1600-MHz FSB, 35 W), a graphics subsystem with 1-GB of discrete memory, and the Windows 8 Standard operating system	729844-501
	Equipped with an Intel Dual Core i3-3110M 2.40-GHz processor (3.0-MB L3 cache, 1600-MHz FSB, 35 W), a graphics subsystem with 1-GB of discrete memory, and the Linux operating system	729844-001
	Equipped with an Intel Dual Core i3-3110M 2.40-GHz processor (3.0-MB L3 cache, 1600-MHz FSB, 35 W), a graphics subsystem with UMA memory, and the Windows 8 Professional operating system	729843-601
	Equipped with an Intel Dual Core i3-3110M 2.40-GHz processor (3.0-MB L3 cache, 1600-MHz FSB, 35 W), a graphics subsystem with UMA memory, and the Windows 8 Standard operating system	729843-501
	Equipped with an Intel Dual Core i3-3110M 2.40-GHz processor (3.0-MB L3 cache, 1600-MHz FSB, 35 W), a graphics subsystem with UMA memory, and the Linux operating system	729843-001

Item Component Spare part number	
Thermal Material Kit (includes thermal replacement material) 719864-001	
(7) Fan (includes cable) 719860-001	
(8) Processor (includes replacement thermal material):	
AMD A10-5750M 2.50-GHz processor (turbo up to 3.50-GHz; 1600-MHz FSB, 4.0-MB L2 cache, DDR3, quad core, 35 W)	713548-001
AMD A8-5550M 2.10-GHz processor (turbo up to 3.10-GHz; 1600-MHz FSB, 4.0-MB L2 cache, DDR3, quad core, 35 W)	713551-001
AMD A6-5350M 2.90-GHz processor (turbo up to 3.50-GHz; 1600-MHz FSB, 1.0-MB L2 cache, DDR3, dual core, 35 W)	713550-001
AMD A4-5150M 2.70-GHz processor (turbo up to 3.30-GHz; 1600-MHz FSB, 1.0-MB L2 cache, DDR3, dual core, 35 W)	713549-001
Intel Quad Core i7-4702MQ 2.20-GHz processor (SC turbo up to 2.90-GHz; 1600-MHz FSB, 6.0-MB L3 cache, 37 W)	723522-001
Intel Quad Core i7-3632QM 2.20-GHz processor (SC turbo up to 3.2-GHz; 1600-MHz FSB, 6.0-MB L3 cache, 35 W)	701658-001
Intel Dual Core i5-3230M 2.60-GHz processor (SC turbo up to 3.20-GHz; 1600-MHz FSB, 3.0-MB L3 cache, 35 W)	711903-001
Intel Dual Core i3-3130M 2.60-GHz processor (1600-MHz FSB, 3.0-MB L3 cache, 35 W)	713163-001
Intel Pentium 2030M 2.50-GHz processor (1600-MHz FSB, 2.0-MB L2 cache, dual core, 35 W)	713164-001
Intel Pentium 2020M 2.40-GHz processor (1600-MHz FSB, 2.0-MB L2 cache, dual core, 35 W)	700628-001
Thermal Material Kit (includes thermal replacement material) 719864-001	
(9) Heat sink (includes replacement thermal material):	
Heat sink for use only on computer models equipped with an AMD A10, A8, A6-5350, or A4 processor and a graphics subsystem with discrete memory	720690-001
Heat sink for use only on computer models equipped with an AMD A10, A8, A6-5350, or A4 processor and a graphics subsystem with UMA memory	720689-001
For use only on computer models equipped with an AMD A6-5200 and a graphics subsystem with discrete memory	724885-001
For use only on computer models equipped with an AMD A6-5200 and a graphics subsystem with UMA memory	724884-001
For use only on computer models equipped with Intel processor and a graphics subsystem with discrete memory	719862-001
For use only on computer models equipped with Intel processor and a graphics subsystem with UMA memory	719861-001
PCH heat sink 719863-001	
Thermal Material Kit (includes thermal replacement material) 719864-001	

Item	Component	Spare part number
(10)	RTC battery (includes cable and double-sided tape)	637193-001
(11)	Optical drive connector cable	719846-001
(12)	Speakers (include left and right speakers and cables)	719865-001
(13)	Power connector cable	719859-001
(14)	RJ-45/USB board (includes cable)	719844-001
(15)	Battery:	
	6-cell, 62-Wh, 2.80-Ah, Li-ion battery	710417-001
	6-cell, 47-Wh, 2.20-Ah, Li-ion battery	710416-001
(16)	Base enclosure (includes 4 rubber feet, battery lock latch, battery release latch, and RJ-45 cover)	719866-001
	Rubber Kit (not illustrated, includes front and rear rubber feet and display bezel rubber screw covers)	719858-001
(17)	DVD±RW Double Layer SuperMulti Drive	719874-001
(18)	Hard drive (does not include hard drive bracket or hard drive connector cable):	
	1-TB, 5400-rpm, 9.5-mm for use on all computer models	676521-001
	750-GB, 5400-rpm, 9.5-mm for use only on computer models equipped with an AMD processor	634250-001
	750-GB, 5400-rpm, 9.5-mm for use only on computer models equipped with an Intel processor	644351-001
	640-GB, 5400-rpm, 9.5-mm for use on all computer models	669300-001
	500-GB, 5400-rpm, 9.5- and 7.0-mm for use only on computer models equipped with an AMD processor	644683-001
	500-GB, 5400-rpm, 9.5- and 7.0-mm for use only on computer models equipped with an Intel processor	683802-001
	320-GB, 5400-rpm, 9.5- and 7.0-mm for use only on computer models equipped with an AMD processor	622643-001
	320-GB, 5400-rpm, 9.5- and 7.0-mm for use only on computer models equipped with an Intel processor	645193-001
	Hard Drive Hardware Kit (not illustrated, includes hard drive bracket and hard drive connector cable)	716179-001
(19)	Memory module (PC3L, 12800, 1600-MHz):	
	8-GB	693374-001
	4-GB	691740-001
	2-GB	691739-001
(20)	WLAN module:	
	Mediatek MT7630E 802.11bgn Wi-Fi Adapter and Mediatek Bluetooth 4.0 Adapter for use only on computer models equipped with an AMD processor	710418-001

Item Component Spare part number

Atheros AR9485 802.11b/g/n WiFi Adapter for use on all computer models 675794-001

Ralink RT3290LE 802.11b/g/n 1x1 WiFi and Bluetooth 4.0 Combo Adapter for use on all computer models 690020-001

Realtek RTL8188EE 802.11bgn Wi-Fi Adapter for use on all computer models 709848-001

Intel Centrino Wireless-N 2230 Combo Adapter for use only on computer models equipped with an Intel processor 670290-001

(21) Service cover 719872-001

Display assembly subcomponents

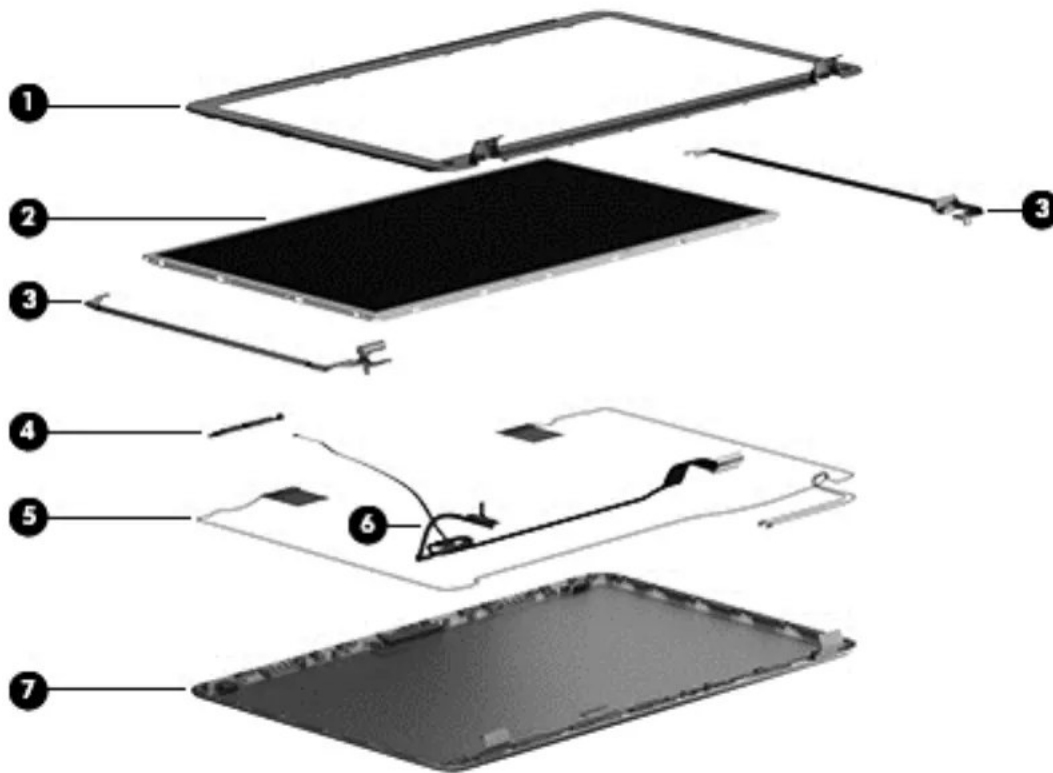

Item Component Spare part number

(1) Display bezel 719847-001

(2) 15.6-in, BrightView, HD, LED, SVA display panel 719873-001

(3) Display hinges (includes left and right hinges and hinge brackets) 719857-001

(4) Webcam/microphone module (includes double-sided adhesive) 719845-001

(5) Antenna Kit (includes left and right wireless antenna cables and transceivers) 719856-001

(6) Display panel cable (includes webcam/microphone module cable) 719854-001

(7) Display enclosure:

In flying red finish 719849-001

In pearl white finish 719848-001

In regal purple finish 719851-001

In revolutionary blue finish 719850-001

In sparkling black and silver finish 719852-001